

NORTEM

2020 Collection

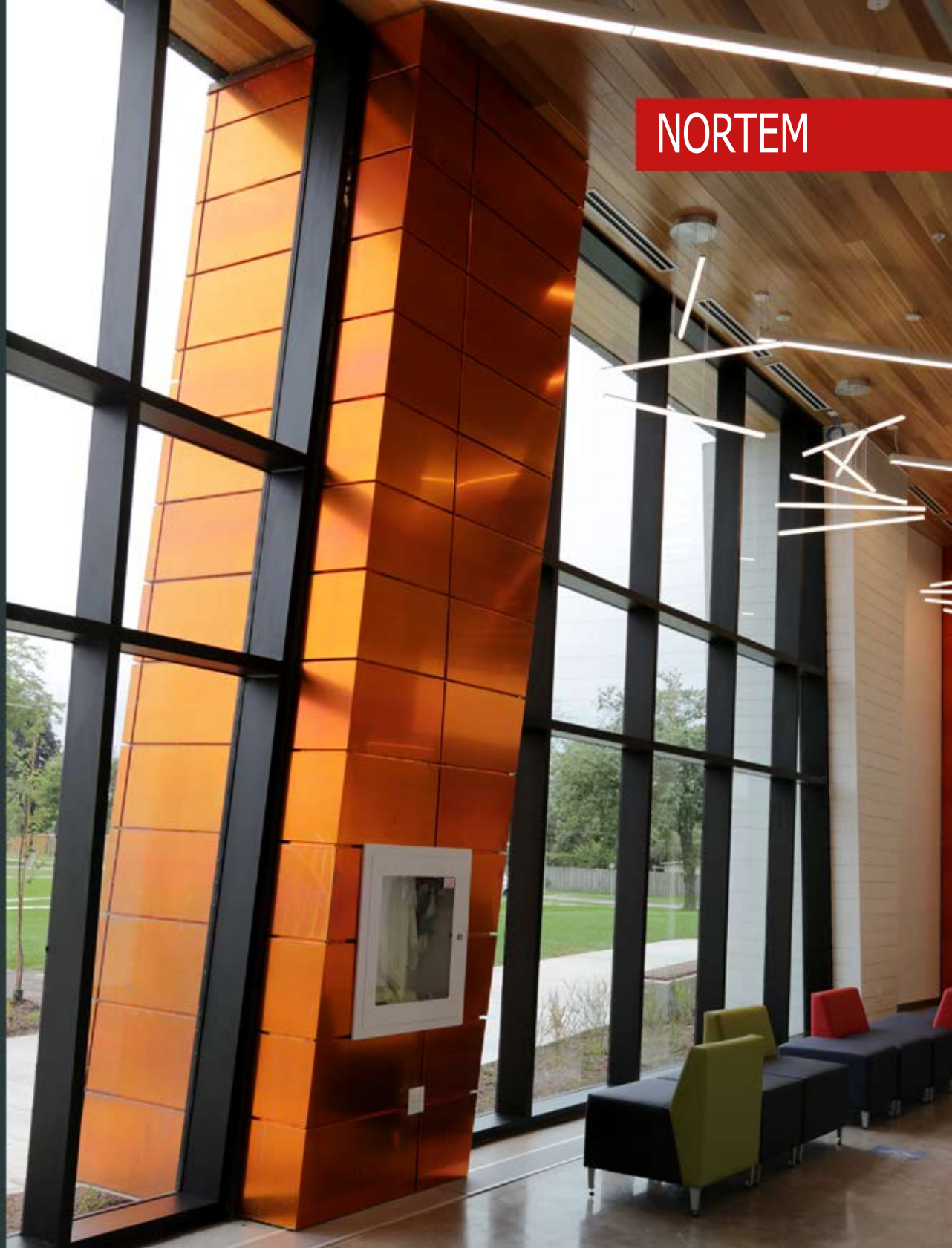

Design
Fabricate
Install



We Design

Nortem advises its clients on the best way to develop, design and procure the building envelope, using our knowledge of the supply chain to provide high-level technical advice across the design process, including choice of materials and systems. Our aim is to achieve a cost-effective, viable design solution providing top performance at the lowest possible risk.

Nortem is on the forefront of the full envelope Architectural Cladding Industry. We are committed to delivering high-quality Panels to diverse customers and market segments.

We are Architectural innovators; a panel manufacturer located in Toronto. Our facility is dedicated to providing exceptional architectural products for use across Canada.



It is the combination of our expertly trained staff, in conjunction with the latest production machinery, that enables Nortem to offer high-quality building exterior

products throughout North America.

The products that we manufacture for the construction sector must be extremely reliable.

They must stand days, months and years. Our customers must be sure that they can rely on this consistency, which we are determined to provide by maintaining the high-quality level of our production.

Supplying top-quality facade products to our customers requires not only excellent engineering and architectural design, but also outstanding manufacturing quality.

Our employees are well trained and highly motivated. We use the latest manufacturing technologies for the highest precision and lowest tolerance.

Our manufacturing is done in our own factory to prevent any extra cost and to provide quick service to our customers.



We Fabricate





We Install

The principle behind designing our panels longitudinally is due to their flexibility and adaptability with any form and shape of façade that architects design. Panels can be installed vertically or horizontally and are always ready to install right out of the box.

Our mounting system consists of aluminum extruded or stainless steel profiles, are fastened onto the wall vertically or horizontally depending on the direction of your panels but usually perpendicular with each other. The required spacing in-between each panel depends on the design and sometimes limited to dimensions.

Nortem's Panel is capable of being installed multi-directional on a variety of substrates such as concrete, cement blocks, plywood and dense glass. Depending on the nature of the application, the architect chooses the appropriate building paper, either a weather barrier or waterproofing membranes such as Tyvek or Blueskin.



Products

ACM Aluminum Composite Material

Perforated & Plate

Decorative metal panels

Honeycomb Stone

Products

ACM Aluminum Composite Material

Aluminum composite panel refers to a new type of building materials which has a series of excellent performance. It has been widely applied in curtain wall, outdoor and indoor decoration and other fields since it's created a new opening in a world of contemporary architectural design.

Thickness: 4mm Aluminum Composite Material
Joint Type: Dry or Caulked Joint
Standard reveal Size: 1/2"

Perforated & Plate

Aluminum Plate Panel Systems, made from solid aluminum, this panel material is dependable and has superior durability. It can be perforated or punched. Available in numerous size and finishes, aluminum plate has numerous fabrication and design options for both small and monumental projects.

Material: 1/8" (~3mm) Aluminum Plate
Joint Type: Dry Joint
Standard reveal Size: 1/2"

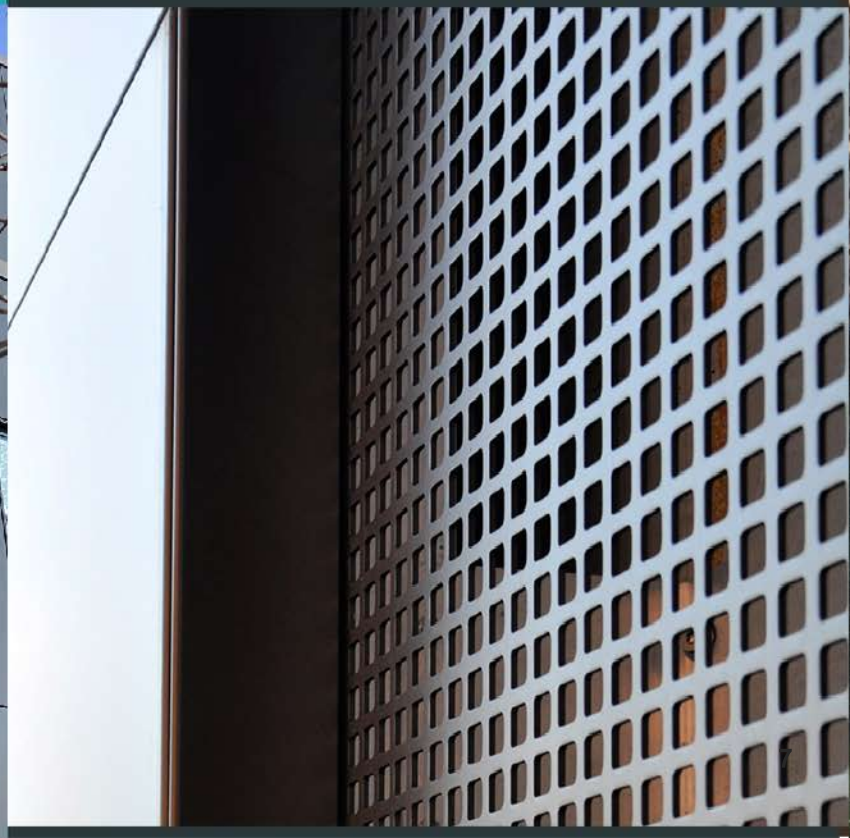

Decorative metal panels

Honeycomb Stone



We offer the commercial building industry the absolute highest quality and best value in metal roof and wall systems. Our heavy-gauge commercial panels require little maintenance throughout their long lifespans.



Honeycomb cladding is the composite material structure for extreme strength, low weight and rain screen systems with a high variety of finishes.

ACM

Aluminum Composite Material

Residential

A building's facade is its signature and the way it presents itself to the world. This means there's an infinite number of options to explore, but maybe few of them are the right choice.



Why Aluminum Composite Panels Are the Best Choice for Modern Buildings?

Designing and constructing structures in modern commercial and residential applications poses challenges like never before.

Clients demand superior durability and performance against the external and internal hazard, yet they're no longer satisfied with purely functional buildings that offer little aesthetic value either. At the same time contractors are faced with the task of balancing limited construction budgets with strict health and safety requirements.

Residential



ACM/Fr

ACM/fr is a fire-retardant panel composed of two thin panels of aluminum laminated to either side of a mineral-filled thermoplastic core. The aluminum surfaces have been coil-coated before bonding with an advanced Lumiflon® FEVE resin in a variety of finishes and colours.

Fire safety is important for any building project, and a fire-retardant panel is typically required in buildings that exceed a minimum height as specified by applicable codes.





Benefits of ACM

- **Durable** – The first thing to note is that the plastic core, central to the composite panels is made from fire-rated substances offering certified, tested fire resistance. Unlike other metals composite panels are rustproof, allowing them to retain, size, shape and integrity when exposed to even the harshest weather conditions. This makes them a great choice for cladding. On average ACMs last far longer than comparable alternatives, further increasing their cost-effectiveness.
- **Versatile** – We've already mentioned how ACMs can be cut to any size and shape, but they also come with the added benefit of availability in a diverse array of colours. You can even find ACMs that mimic the tone and texture of natural materials like stone, and wood; or even brick.
- **Easy to Maintain** – ACMs are waterproof and stain-resistant, making them easy to clean. Simple dust down with a cloth will remove any accumulated dust and grime.
- **Insulation** – These panels are light and heat reflective making them a great choice for building facades, they'll also help you maintain room temperature when used in interior construction.
- **Easy installations** – aluminum is an extremely lightweight, flexible material that's far simpler to handle than steel or wood. That means ACM applications are far less labour-intensive, and large stocks can be easily stored as well.
- **Affordable** – While generally commercial buildings require panels that are at least 4mm thick, these can be cut to various sizes and shapes depending on the requirements of the structure; Which makes ACMs far more cost-effective than solid sheet building materials.

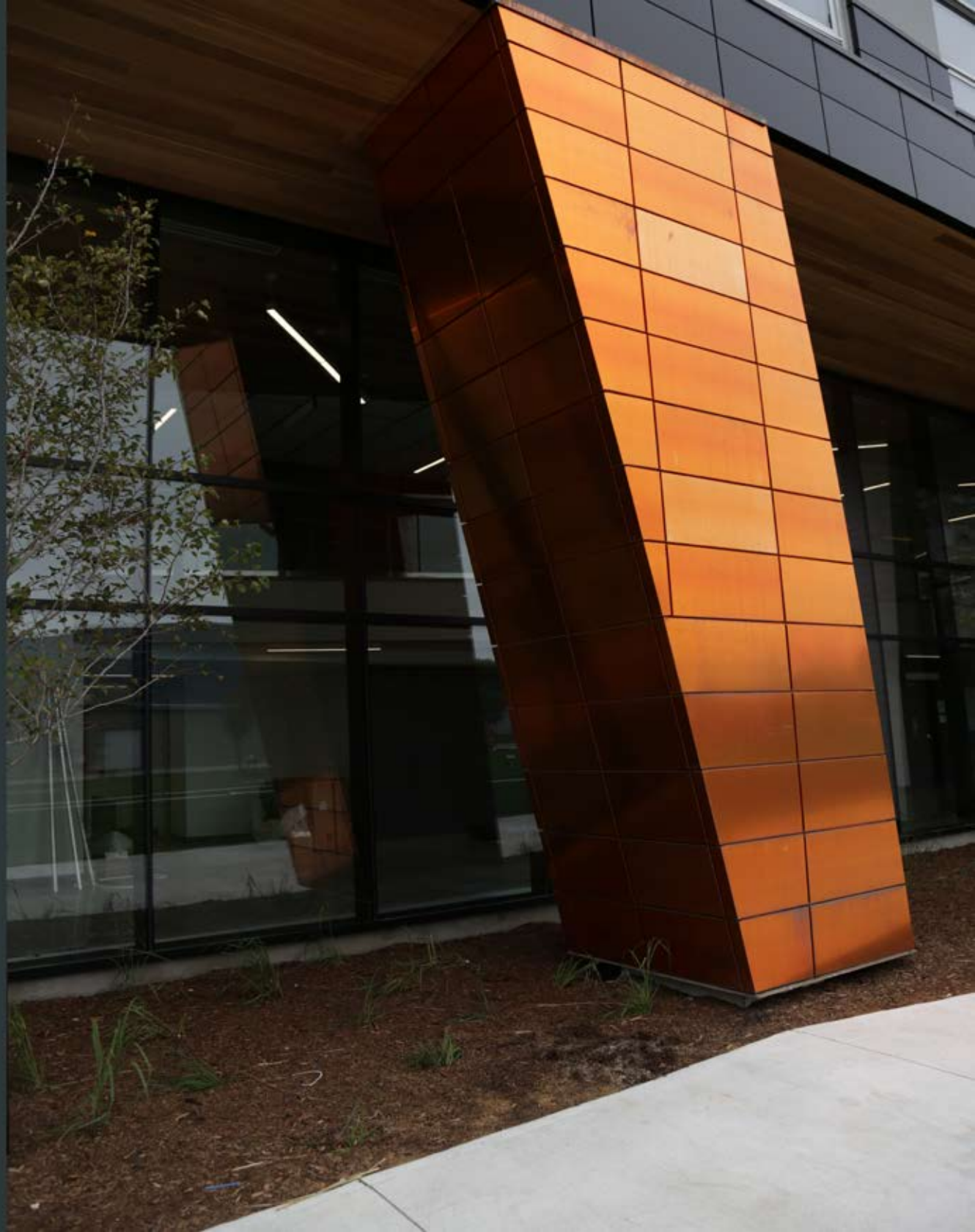

Alpolic
MCM Copper

**Perforated,
Punched &
Plate Panels**

16
17

Perforated Facade Panel

Cladding a building with perforated metal is a very effective way to enliven the facade of what would otherwise be a simple cubed structure. From uniform circular perforations to honeycomb-patterned latticework and mesh, through to three-dimensional forms, perforated cladding has the ability to add depth, texture and intrigue to a façade. Perforated cladding provides a practical purpose, too. Depending on the size of perforations, the amount of natural light reaching the inside of the building can be managed.



Nortem panels are manufactured from 3mm to 6mm thick ACM, MCM or sheet metal. Our team of technicians can help you with live loadings that would be applied to the building with a perforated façade. We can also help with calculating the number of perforations or size of eyes within the mesh, either required for aesthetics or air flow requirements. Our perforated panels are hung from the façade using the aluminium support system.

Plate

Aluminum Plate is made from solid aluminum, aluminum is dependable and has superior durability. Nortem provides plates in numerous sizes and finishes. In specific projects, aluminum plate systems have an advantage over Aluminum Composite Material (ACM). Aluminum plate is a flexible system that allows the option of clean flat lines or curvilinear construction involving bending.

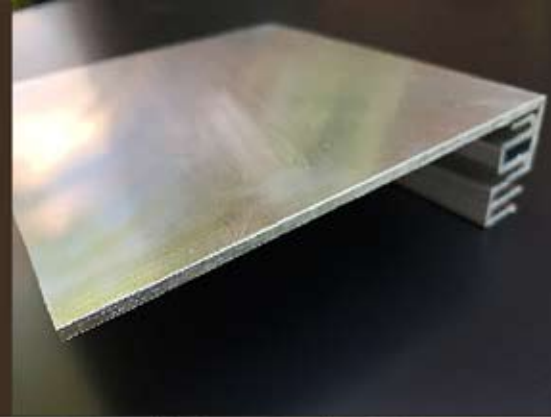

1/8" (3mm) Aluminum Plate is typically the material of choice for very complex shapes requiring seamless detailing as well as smaller projects requiring customized or unique colours.

Decorative Panels



- 9
- 10
- 11
- 12
- 13
- 15

Decorative Panels

Corrugated

Very popular among architects, Nortem's 7/8" Corrugated profile features panels with exposed fasteners and no hard lines, resulting in a highly consistent appearance and a more organic overall look. Panels are available in a variety of widths, thicknesses and finishes.

Corrugated Wall Panels are about performance on a large scale. These panels tend to be deeper and thicker than other panels to span longer distances and resist greater loads.





Decorative Panels

Think Corrugated

We offer the residential and commercial building industry the absolute highest quality and best value in metal roof and wall systems. Our heavy-gauge corrugated panels require no maintenance throughout their long lifespans. Custom profiles and architectural listed colours help ensure your project will perform beautifully – and sustainably decade after decade.

Cassette

Panel Systems

Decorative Panels

Versatility is perhaps the most important benefit provided by Cassette cladding systems. Not only can cassette panels be applied to a multitude of substrates including concrete, brickwork and metal, but they can also be customized in shapes, material, colours and textures that suit the overall vision of the architect and contractor.



Nortem Cassette Panel is a type of cladding system. Cassette panels are %100 recyclable, reasonable in price and with the very modern appearance on the building fascia. It can be used for exterior, interior, new construction and renovation projects.

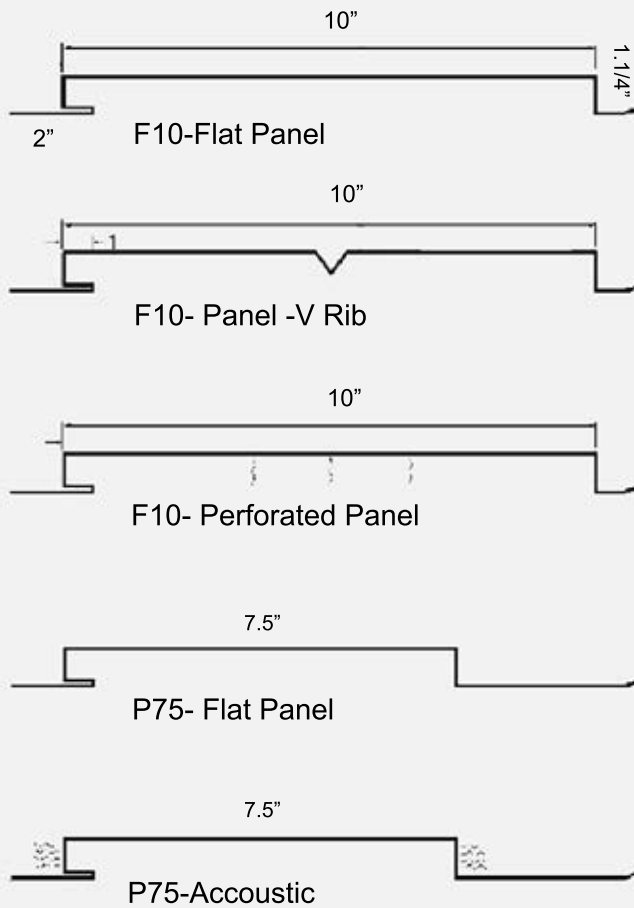

F10- Perforated



F10- Flat Panel



F75- Accoustic Panel

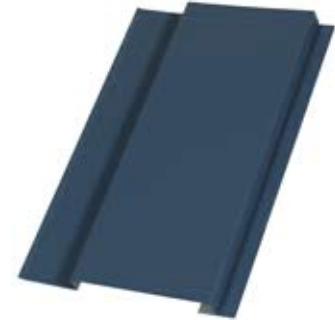

F75- Flat Panel

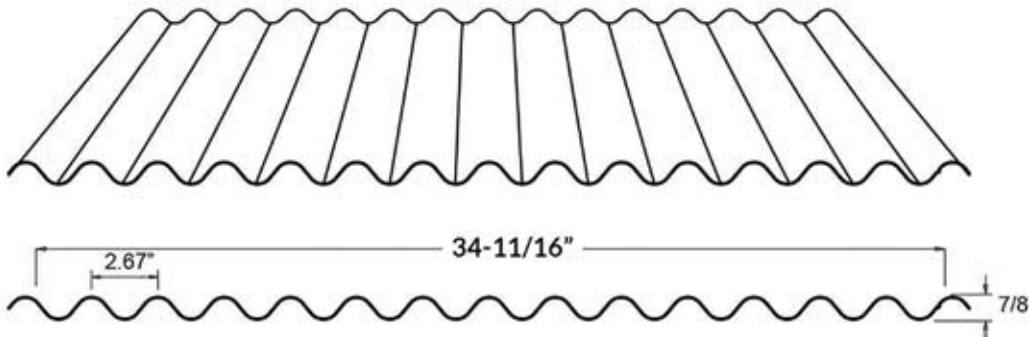

For walls, fascia, or soffits, Nortem's complete line of Hidden Fastener Decorative Metal Panels is ideal for a variety of applications. Available for immediate shipment, these decorative panels are available in custom lengths up to 20' in a range of colours, and in vented (round or slotted holes) or non-vented variants.

Honeycomb Stone

24
25

Honeycomb Stone

Lightweight stone honeycomb panels offer excellent options for almost any construction product where you're looking for that natural stone look, but without the weight or fragility that typically accompanies most of the natural stone slabs.



The lightweight natural stone panels consist of a very thin layer of natural stone, reinforced by ultra-light honeycomb composite. Thus reducing the weight of dimensional stone by more than 80%, making it an ideal solution for applications such as commercial industry, residential and condos.

Multiple Installation Methods For Honecomb Stone



There are different types of Nortem composite panels to suit your needs, however, they are all designed to work together in a seamless, highly engineered and integrated system. Each panel can be mounted onto the building structure in one of four ways (Interlocking Channels, Z-Clips, Anchor Plates, or Adhesive) depending on the application and underlying material (drywall, metal or wood studs, concrete, pre-existing stone, or other materials).

These mounting methods create varying depths of space in the building envelop to accommodate wiring, conduits, and to provide for aeration.

INTERLOCKING CHANNEL SYSTEM

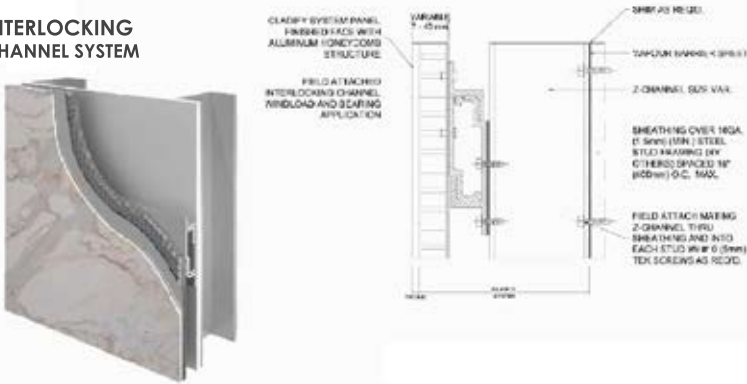

Z-CLIPS SYSTEM

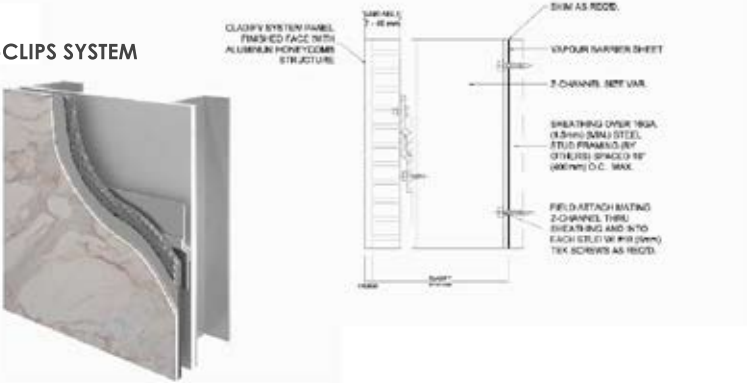

ANCHOR PLATE

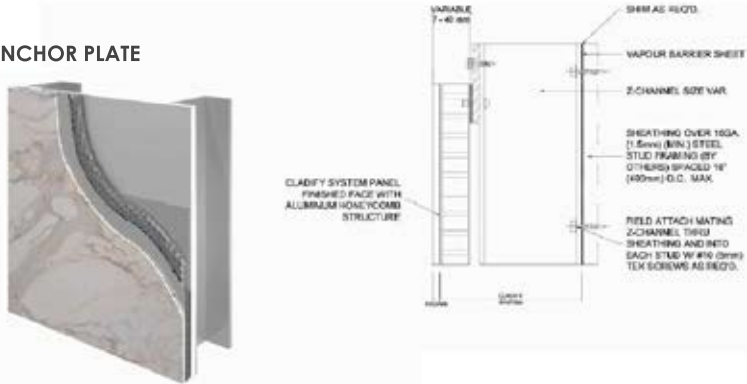

ADHESIVE ATTACHMENT

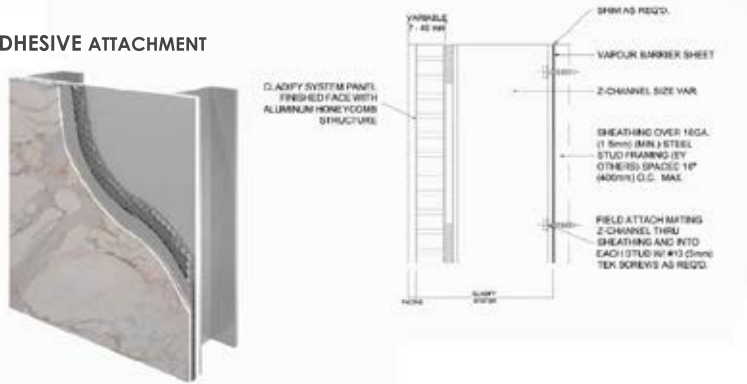

Specs & Finishes

SOLID



Bone White
4-BNT-30
LRV 78.50/SRI 82-Cool



Oyster
4-CRT-30
LRV 72.46/SRI 82-Cool



Mist White
4-MST-30
LRV 69.96/SRI 75-Cool



Aluminum Grey
4-AGT-30
LRV 31.60/SRI 26



BGY Grey
4-BGY-50
LRV 10.41/SRI 7

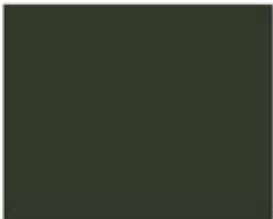

Bronze
4-JBR-30
LRV 3.34/SRI 2

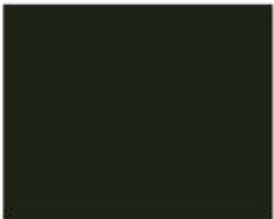

TOB Black
4-TOB-15
LRV 1.01/SRI 0

MICA



Mica Platinum
4-OPT-50
LRV 30.88/SRI 53-Cool



Mica Anodic Clear
4-MNC-30
LRV 34.43/SRI 56-Cool



Mica Champagne
4-MCU-30
LRV 22.61/SRI 38-Cool



Mica Grey
4-MZG-50
LRV 7.95/SRI 14



Mica MFS Grey
4-MFS-30
LRV 13.41

METALLIC



BSX Silver Metallic
4-BSX-30
LRV 30.94/SRI 71-Cool



Silver Metallic
4-SMX-30
LRV 36.59/SRI 63-Cool



Champagne Metallic
4-CMX-30
LRV 31.19/SRI 59-Cool



Medium Bronze Metallic
4-MBX-30
LRV 31.20/SRI 40-Cool



Dark Copper Metallic
4-DCX-30
LRV 15.09/SRI 47-Cool

SOLID



BBR Red
4-BBR-30
LRV 8.06
3&4mm



BTR Red
4-BTR-50
LRV 11.57
3&4mm



TOR Red
4-TOR-70
LRV 9.06



JLR Red
4-JLR-50
LRV 5.44



JXR Red
4-JXR-30
LRV 10.50



TRC Red
4-TRC-30
LRV 8.52



AUB Blue
4-AUB-50
LRV 3.25



CVB Blue
4-CVB-70
LRV 13.79



HNB Blue
4-HNB-50
LRV 16.78



RTB Blue
4-RTB-60
LRV 9.06



MBU Blue
4-MBU-30
LRV 10.59



HYB Blue
4-HYB-30
LRV 4.20



ABE Blue
4-ABE-70
LRV 23.73



AYW Yellow
4-AYW-70
LRV 61.77



HYE Yellow
4-HYE-50
LRV 62.5

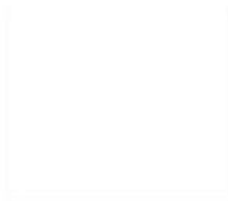

RVW White
4-RVW-G50
LRV 86.34



HWH White
4-HWH-50
LRV 80.8



COW White
4-COW-30
LRV 68.67



BLX Black
4-BLX-30
LRV 0.89
3&4mm



TBL Black
4-TBL-70
LRV 0.75
3&4mm

SOLID



CVG Grey
4-CVG-50
LRV 14.38
3&4mm

METALLIC



PEX Pewter Metallic
4-PEX-30
LRV 20.63



TSZ Silver Metallic
4-TSZ-70
LRV 32.00



TBX Silver Metallic
4-TBX-70
LRV 38.75
3&4mm



TXG Grey
3-TXG-70
LRV 40.69

SOLID

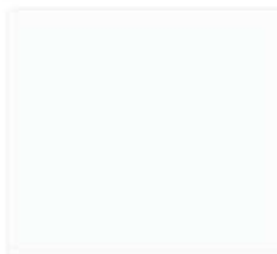
**STR Red**3-STR-70
LRV 12.55**TRD Red**3-TRD-70
LRV 10.26**FEF Red**3-FEF-70
LRV 11.64**BPS Pearl**3-BPS-30
LRV 68.79**ETT Tan**3-ETT-30
LRV 47.87**CRY Oyster**3-CRY-50
LRV 72.30**CTW White**3-CTW-30
LRV 76.42**MCV White**3-MCV-70
LRV 68.21**SAW White**3-SAW-70
LRV 80.62**EWH White**3-EWH-30
LRV 90.01**DYB Blue**3-DYB-50
LRV 10.06**CFB Blue**3-CFB-70
LRV 7.24**SHB Blue**3-SHB-70
LRV 4.12**BGN Green**3-BGN-50
LRV 14.39**BYL Yellow**3-BYL-50
LRV 65.93**EYL Yellow**3-EYL-30
LRV 48.05**YLW Yellow**3-YLW-50
LRV 49.88**SBR Bronze**3-SBR-30
LRV 6.32**CNC Charcoal**3-CNC-30
LRV 4.20**SOG Grey**3-SOG-70
LRV 49.50

STONE SERIES | 20 Year Finish Warranty



Black Granite
4-LBG-70
LRV N/A

TIMBER SERIES | 20 Year Finish Warranty



Maple
4-MPL-30
LRV N/A



Walnut
4-WLN-30
LRV N/A



Mahogany
4-QAE-30
LRV N/A

PRISMATIC



MRT Prismatic Magma
10 Year Finish Warranty
3-MRT-70
LRV 11.33

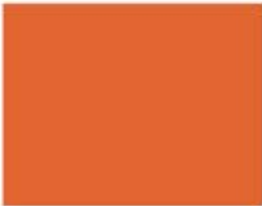

DQO Pearlescent Orange
10 Year Finish Warranty
3-DQO-70
LRV 22.21

DECORATIVE



HPA High Polished Aluminum
5 Year Finish Warranty
3-HPA-70
LRV 0.88



HLZ Hairline Aluminum
10 Year Finish Warranty
4-HLZ-70
LRV 16.32

MULTI-COLOR



Red/White
10 Year Finish Warranty
3-209-70
LRV 11.64/SRI 80.90



Blue/White
10 Year Finish Warranty
3-207-70
LRV 8.00/SRI 81.04



Yellow/White
10 Year Finish Warranty
3-234/238-35
LRV 48.05/SRI 90.01

Architectural Premium Stock Finishes

Call ALPOLIC® Customer Service for Warranty Details 800.422.7270

NATURAL METALS



Stainless
4-4HL
LRV 21.84/SRI 34-Cool



Zinc
4-AZZ
LRV 21.51/SRI 0



Copper
4-C12
LRV 5.03/SRI 55-Cool

ANODIZED



Clear
4-CLR
LRV 34.31/SRI 84-Cool

PLate Sheet Sizes:

46" x 94" (1168mm x 2387mm)
46" x 142" (1168mm x 3606mm)

Standard Plate Thickness:

1/8" to 1/4" ~ 3mm to 6mm

Manufactured Plate Weight:

Approximately 3lbs/SF

Plate Finishes:

Aluminum Plate is post-painted, typically with a PPG Duranar, which allows for an endless possibility of colour choices.

Available in these options:

- Duranar – 2 coat system (primer & colour), solid colours only- Duranar Sunstorm – 2 coat system (primer and mica containing colour), mica finishes
- Duraner XL – 3 coat system (primer, colour, and clear coat), solid, mica and metallic colors available

Warranty: 3 years man power and 20 years finishes for plate



TOB Black

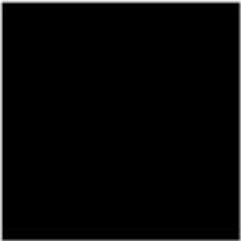

BLX Black



TBL Black



RVW white



HWH White



COW White



Aluminum Grey























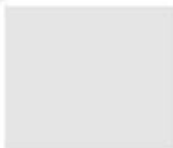





BGY Grey



CNC Charcoal

Corrugated & Decorative Panels

							
QC 28021 Beige Beige	QC 28262 Black Noir	QC 28306 Charcoal Fusain	QC 28326 Coffee Café	QC 28696 Antique Linen Lin antique	QC 28273 Bone White Blanc os	QC 28783 Bright White Blanc vif	QC 28695 Cambridge White Blanc Cambridge
							
QC 28276 Gold Or	QC 28719 Mahogany Brown Brun chêne	QC 28228 Metro Brown Brun métro	QC 28129 Pebble Khaki Caillou kaki	QC 28317 White White Blanc pur	QC 28305 Stone Grey Gris pierre	QC 28269 Tile Red Rouge tuile	QC 28314 Deep Grey Gris foncé
				PLAIN Finis naturels  A606 Corten		GRANITE® DEEP MAT  AZM150 AZ50 AZM180 AZ60 Galvalume Plus	
QC 18-2802 Cherry Woodgrain Cherry Woodgrain	QC 18-2411 Roasted Ash Roasted Ash	QC 18-2964 Silver Birch Silver Birch	QC 28229 Dark Brown Brun foncé				
METALLICS Metallic							
QC 2624 Bright Silver Argent métallisé	QC 3234 Copper Cuivre	QC 2897 Light Pewter Etain	QC 28730 Regent Grey Gris régent	Z275 G90 Galvanized Galvanisé	QC 60035 Graphite Grey Gris graphite	QC 60039 Jet Black Noir de jais	QC 60041 Sepia Brown Brun sépia



Nortem Corp.
61 Rayette Rd
U3, Concord
Ont, L4K 2E8
CANADA

info@nortem.ca
T: 800.898.1310
C: 416.458.7898
NortemCladding.com